



Watch the installation video here

BAR ENDS

FOR STRAIGHT AND SLIGHTLY BENT HANDLEBARS

A

Included in the Package:

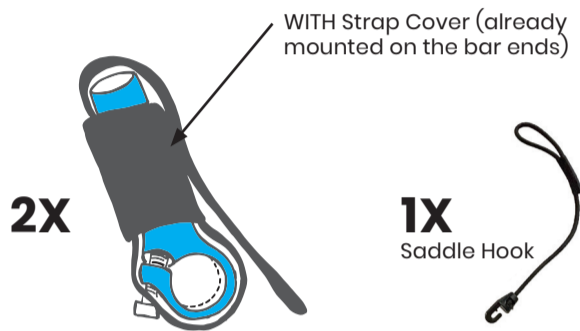

BAR ENDS

FOR STRONGLY BENT HANDLEBARS

B

Optional Included:

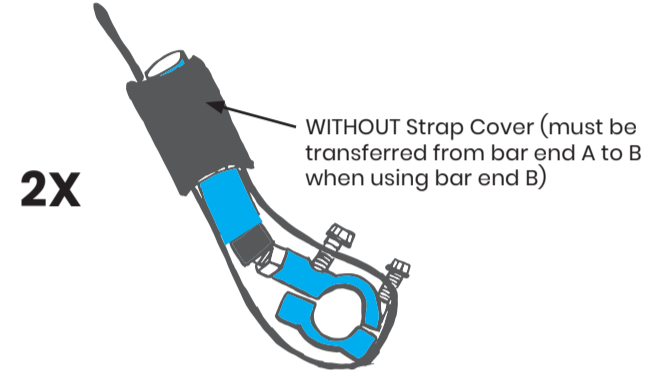

The **one-time initial installation** of Wip requires the assembly of the **included bar ends (1)**. **Bar ends A** are designed for **straight** and **slightly bent** handlebars. **Bar Ends B** are for **strongly bent** or particularly wide handlebars. The bar ends are mounted at the end of the handlebars. For this, it is necessary to **move the handlebar grips approximately 1.5 cm inward**. Typically, the **brake levers, shifters, etc.**, will also need to be moved 1.5 cm inward accordingly.

If you do not have this expertise, please consult a **bicycle mechanic**. Depending on the type of your handlebar grip, it won't take much time for them to complete this. **The safety clip (2)** is attached to a suitable spot under the handlebar using velcro. **The saddle hook (3)** for the parking position is attached by simply looping it under the saddle.

A STRAIGHT AND SLIGHTLY BENT BAR ENDS

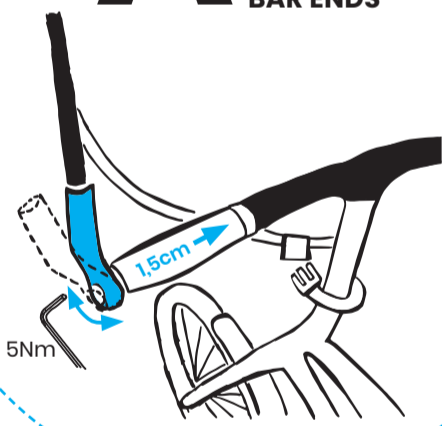

1. Move the handlebar grip 1.5 cm inward. Move the brake levers and shifters, etc., 1.5 cm inward first.
2. Slide the straight **bar end A** with the strap cover onto the handlebar. Initially, tighten the Allen screw slightly.
3. The **bar end A** can be swiveled forward or backward by loosening the M5 Allen screw.
4. Adjust the **bar end** to **your body size** (see page 2).

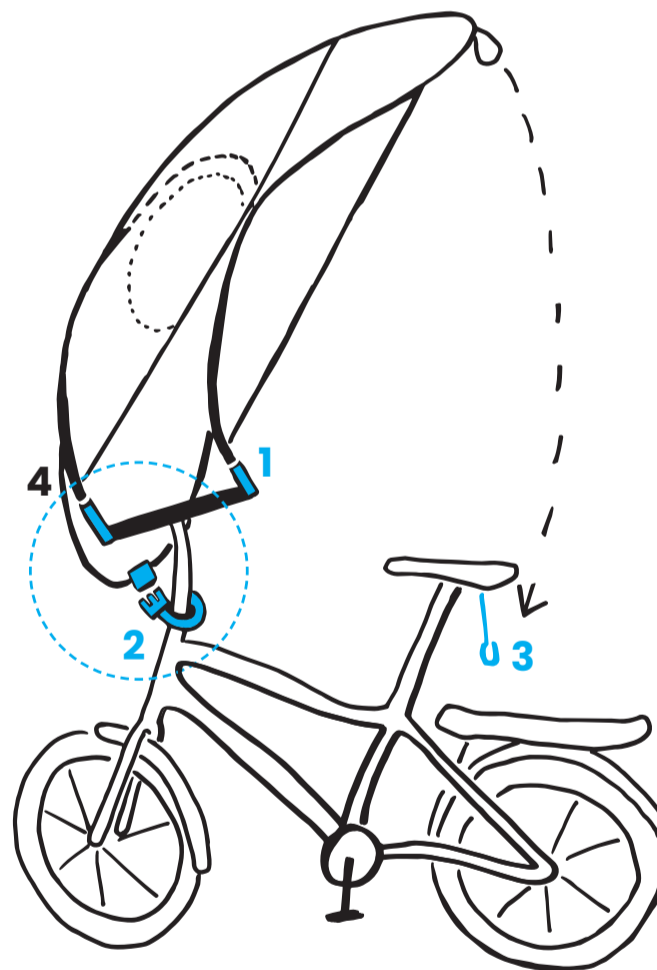

- 1 Bar Ends
- 2 Safety Clip
- 3 Saddle Hook for Parking Position
- 4 Bar End Plug

B STRONGLY BENT BAR ENDS

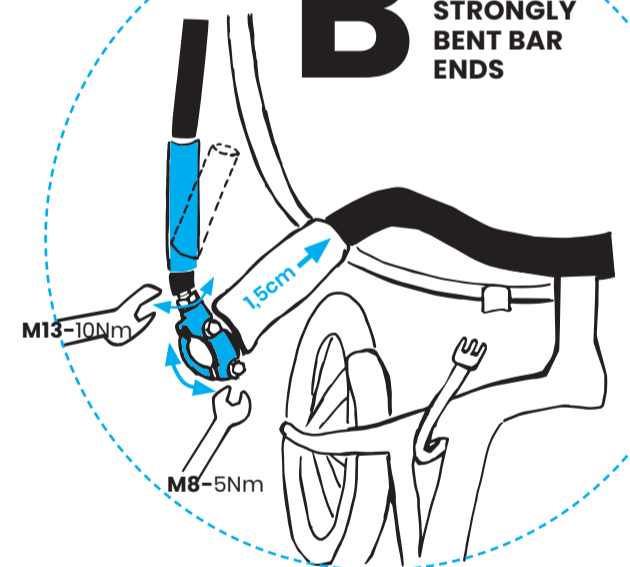

1. Move the handlebar grip 1.5 cm inward. Move the brake levers and shifters, etc., 1.5 cm inward first.
2. Slide the bent **bar end B** with the strap cover onto the handlebar end. The **strap cover** must be transferred from bar end A. Initially, tighten the M8 screws slightly.
3. The **bar end B** can be swiveled forward or backward by slightly loosening the **two M8 nuts**. By slightly loosening the **M13 nut**, the inclination can also be adjusted inward (similar to mounting bicycle mirror brackets).
4. Adjust the **bar end** to **your body size** (see page 2).



FOR VARIOUS HANDLEBAR GRIPS

1. Simple rubber grips at the handlebar end can be cut circularly, and the handlebar plug can be removed or cut off by 2-3 mm.
2. Screwed handlebar grips often have a plastic edge at the handlebar end, indicating that the grip is fully pushed onto the handlebar. This edge can be easily removed with a sharp kitchen knife in a circular motion.
3. If moving your handlebar grip is very difficult or impossible, we recommend using a suitable handlebar grip. The market offers a wide range of options from simple to luxurious.

ADJUST TO BODY SIZE

The distance from Wip to the head or the viewing window is adjusted by tilting the bar ends forward or backward. First, slightly loosen the screws so that the bar ends can be moved by hand. Then tighten the screws again securely.

Here, the head touches the Wip – the bar ends are set **too steeply upward**.

For a shorter distance to the head and the viewing window, tilt the **bar ends slightly forward**.

If a greater distance to the head and the viewing window is desired (for tall people), **tilt the bar ends further forward**.

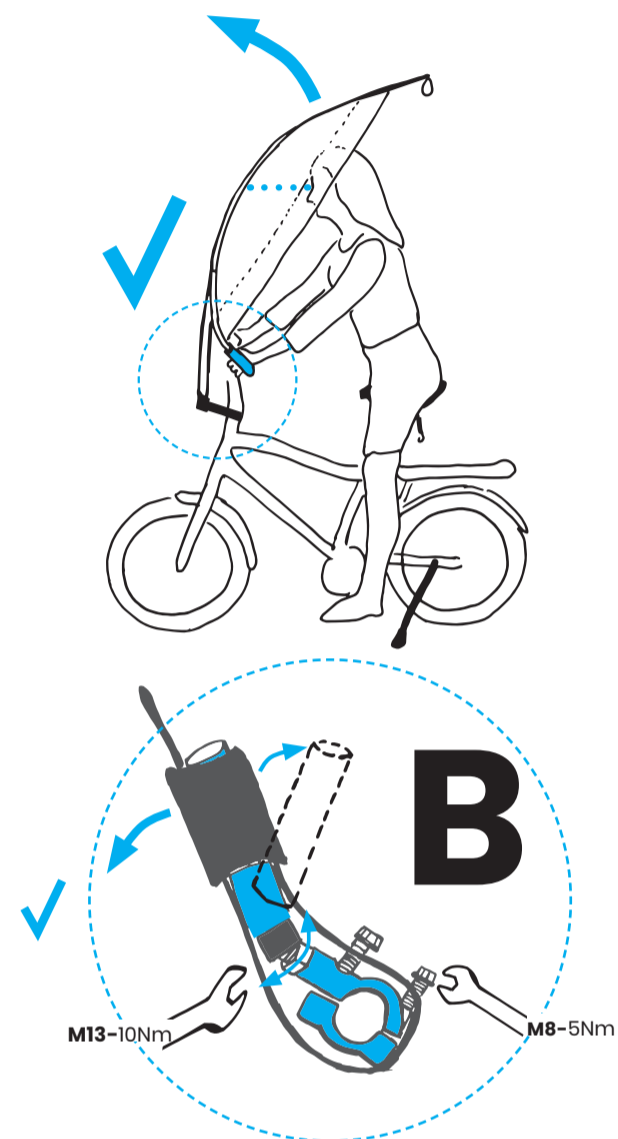
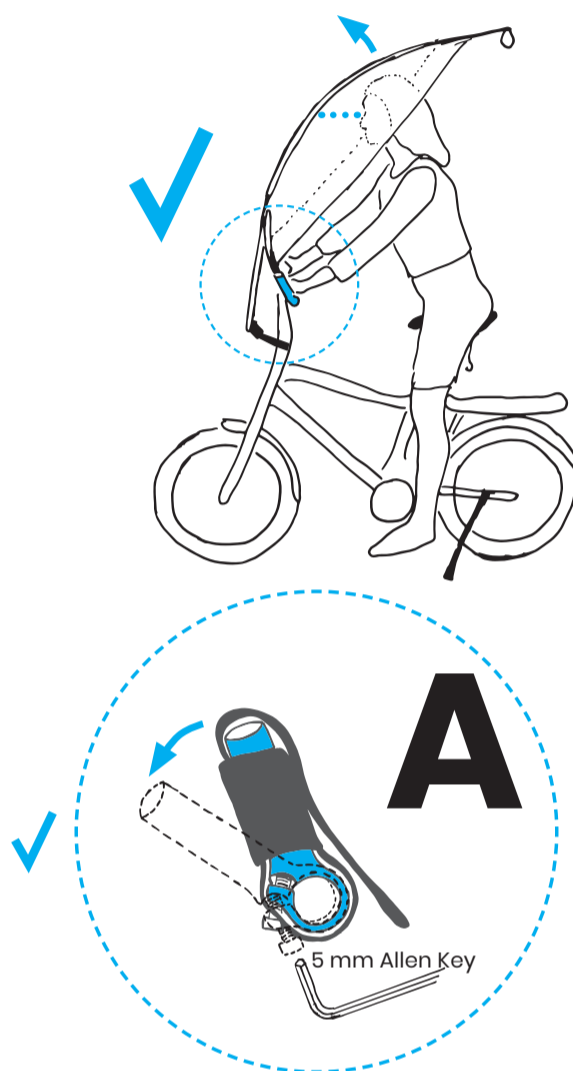
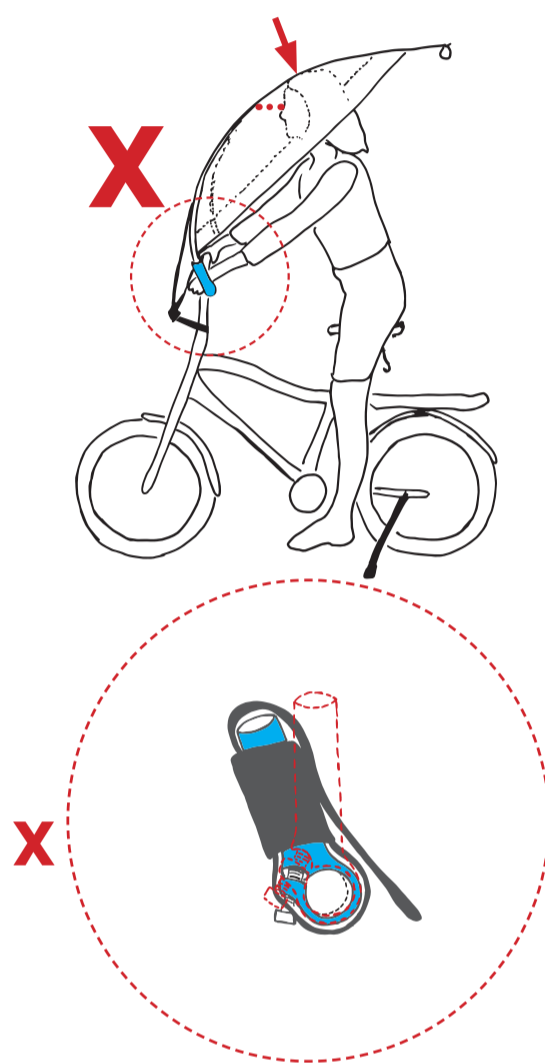

Adjusting Bar End B

With the M8 and M13 nuts slightly loosened, insert the handlebar plugs into the bar ends.

Assume a symmetrical, ride-like position. The viewing window should be approximately 30 cm from your face. Tighten the M8/M13 nuts to 5Nm/10Nm.

GENERAL SAFETY INSTRUCTIONS

Safety Instructions – Please Read Before Using Wip!

The safe and correct use of Wip is important to us and directly influences how much enjoyment you will get from using it. Please always follow these instructions to ensure your safety and that of other road users. It is essential that you thoroughly familiarize yourself with the safety instructions in this manual and consistently follow them every time you use Wip. Wip is designed exclusively for use on a bicycle or eBike with a maximum speed of 25 km/h. Ensure that the weather protection does not impair the handling of the bicycle. The bar ends are not compatible with carbon handlebars.

1. Checking Wip Before Riding:

- Ensure that Wip is securely attached before each ride.
- Check all attachment points, such as velcro straps and buckles, for a secure fit and proper functionality.
- Regularly inspect Wip for signs of wear or damage.

2. Consider Visibility and Environmental Conditions:

- Ensure that Wip does not obstruct your view and that you always adjust your riding behavior according to the prevailing visibility and weather conditions.
- The window may cause light reflections under certain lighting conditions (such as **backlight**, street lighting, low sun, darkness, especially in combination with wet conditions), which can limit visibility.
- Wip should not be used if visibility is impaired.
- Transparent areas must always be clean and free from dirt or fog to ensure clear visibility.
- Wind may cause additional force on the handlebar due to Wip.
- Wip should not be used in strong **winds**.

3. Parking in a Safe Position:

- Always park your bicycle with Wip in the parking position shown in this manual (see page 3).
- In windy conditions, the bicycle should be additionally secured to an object to prevent injuries and damage from the bicycle falling over.

4. Road Safety:

- Always be aware of your surroundings and other road users, especially in bad weather and darkness.
- Ensure that Wip does not cover your bicycle light or other safety-relevant components.
- Use Wip only if you feel safe under the given conditions.
- Overtaking by other road users can cause additional force on the handlebar.



SETTING UP OF WIP

POP UP!

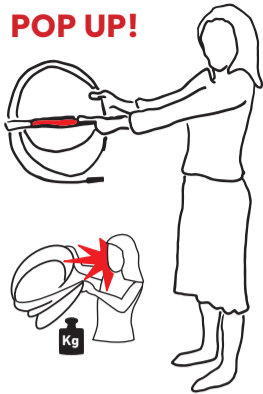

Pay attention to the warning on the safety band! Carefully remove the band. Wip unfolds powerfully on its own, so always hold it firmly.

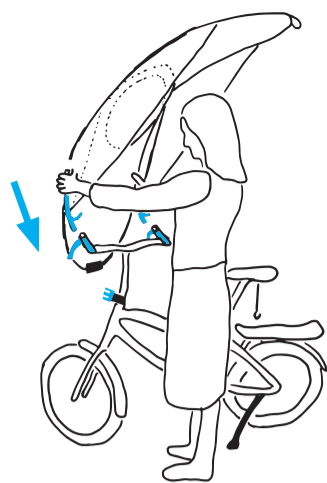

Push the **handlebar plugs** firmly into both open **bar ends**. Then, close the **velcro straps** from the handlebar plug downward and from the bar end upward on the back of the handlebar plug (there are two velcro straps to close on each side).

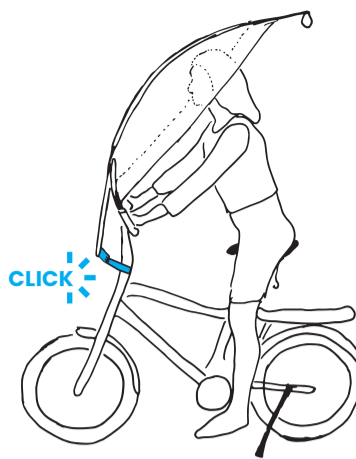

Now close the safety clip under the handlebar with an audible **CLICK**. The elastic band should be under some tension when the clip is closed. Then check that Wip is correctly and securely positioned.

PARKING POSITION

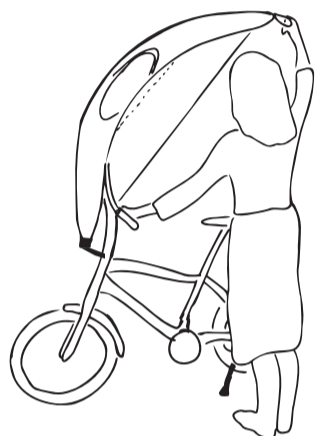

Pull the **rubber loop** at the upper end towards the saddle and...

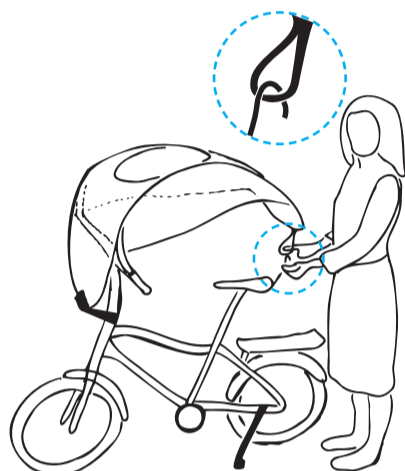

... hook it onto the **saddle hook**.

ALWAYS PARK WIP IN THE PARKING POSITION



Before leaving your bicycle, **always place Wip in the parking position**. This offers many advantages: the parked bicycle and saddle are better protected from **moisture** and from **falling over** in the wind. In very windy conditions, please additionally **secure the bicycle to a post**.

 To protect against **theft**, a simple **cable lock** can be threaded **between the neoprene and fiberglass rod** in the area of the safety clip.

DISMANTLE OF WIP + TRANSPORT

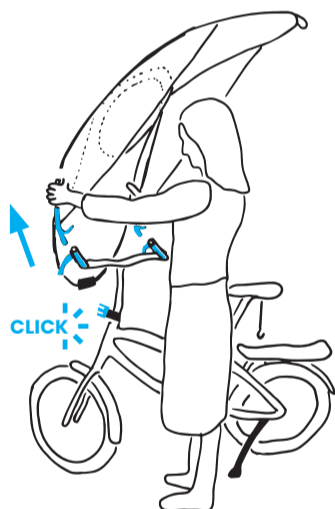

First, **open the safety clip**, then the **double velcro fasteners** on the bar ends, and pull the handlebar plugs upwards out of the bar ends.

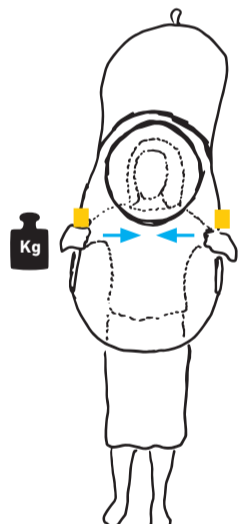

BRING YELLOW MARKINGS TOGETHER



Hold Wip as shown below the yellow markings. Press Wip firmly together in the direction of the arrow so that you **bring the yellow markings together** and form a **8**.



BRING BLUE MARKINGS TOGETHER

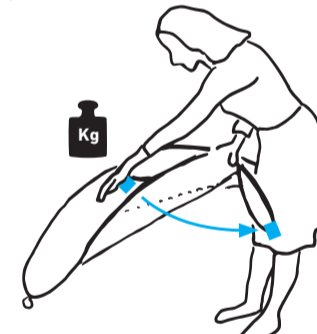

Support the lower part of the **8**, for example on your legs or on a clean surface, and press firmly downward in the direction of the arrow with your free hand so that the **two blue markings are brought together**.

BRING GREEN MARKINGS TOGETHER

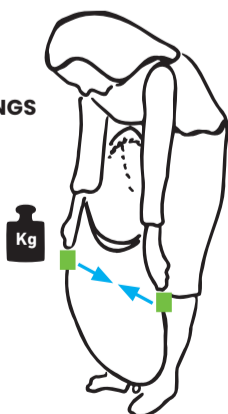

Hold the now overlapping part, secured with your forearms, for example, and press your hands firmly together at the green markings in the direction of the arrow. This will form another **8** (**bring the green markings together**).

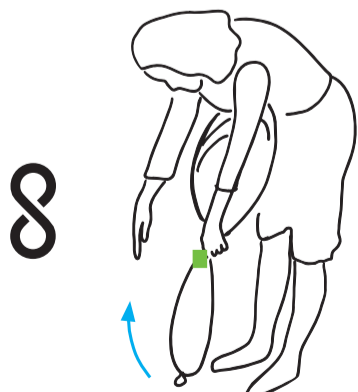

At the crossing point, hold the green markings together with one hand and **fold** the lower part of the **8** upwards in the **direction of the arrow**.



Secure the Wip, folded into a circle, with the **safety band**.

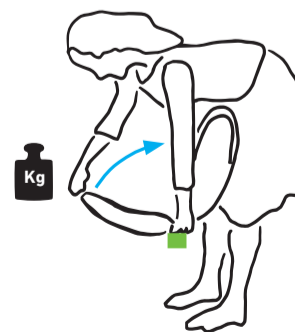

Pack Wip in the bag for transport.

 If the **safety strap** is not close at hand, Wip remains fixed in place when the bag is closed.

WINDSHIELD REMOVE TOP WITH SIDE PANELS

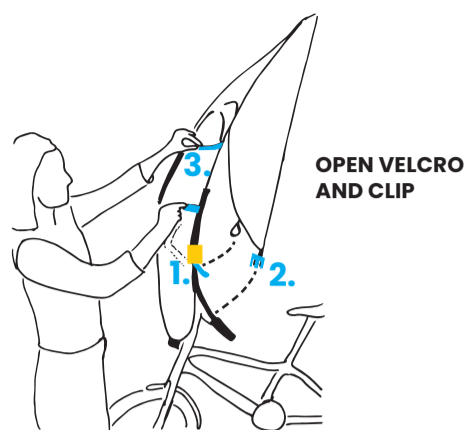

OPEN VELCRO
AND CLIP

1. To remove the top, open the **velcro strap** directly below the yellow marking. The small **elastic band** will loosen. 2. Undo the small clip on the handlebar plug. 3. Release the **double velcro** on the left and right of the viewing window.

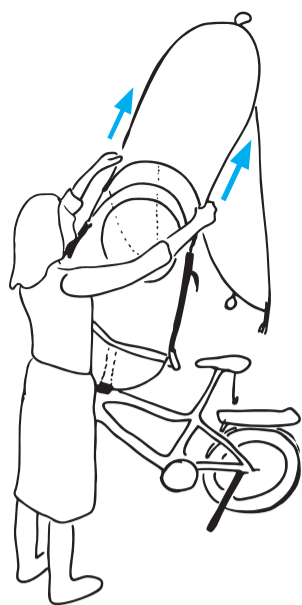

Pull the top upwards out of the **strap pockets** and hang it separately for storage.

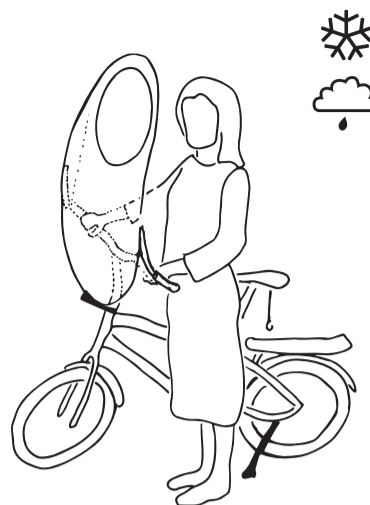

Wip as a constant companion from autumn to spring. Using the windshield provides excellent protection against cold, pollen, insects, and also frontal rain protection during brisk rides.

FOLDING THE WINDSHIELD

The windshield can be folded separately when not in use or for transport. The plastic button at the bottom end and the small elastic loop allow for secure fastening without the safety band.

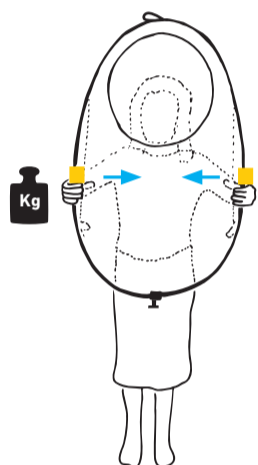

BRING YELLOW MARKINGS
TOGETHER



Hold the crossing point of the 8, where the **yellow markings** meet, firmly together with **ONE hand**.

Hold the windshield as shown below the yellow markings. Press Wip firmly together in the direction of the arrow so that you bring the **yellow markings together** and form a 8.

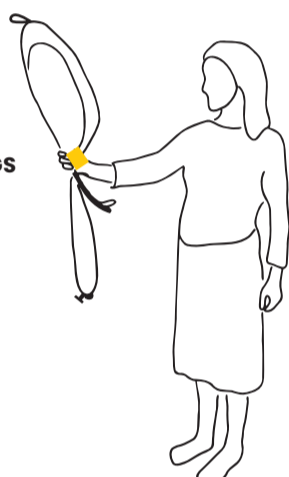

BRING BLUE
MARKINGS
TOGETHER

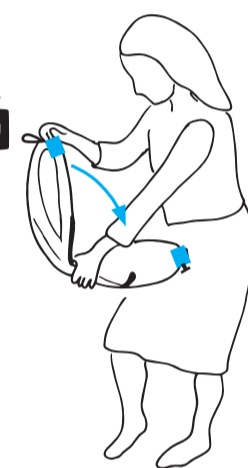

Support the lower part of the 8 and fold the **viewing window** towards you in the direction of the arrow, bringing the **blue markings** together.

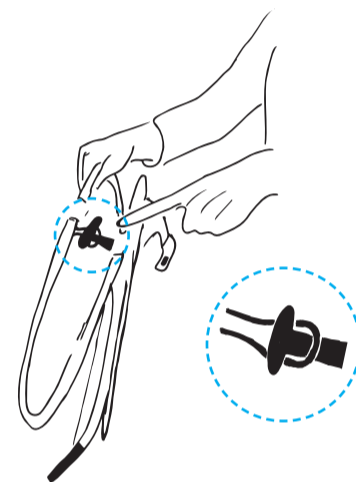

Pass the **button** through the small **elasticated loop** as shown.

WIP IN EVERYDAY USE + TRANSPORT ON THE BICYCLE

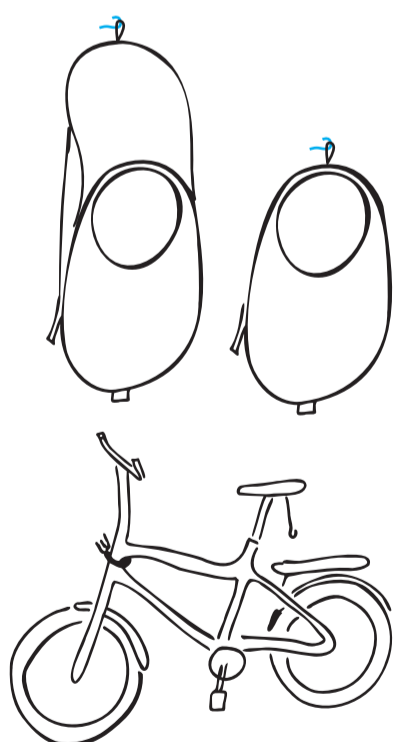

We recommend **storing Wip in its unfolded state**. This prevents **creases, mildew stains**, and allows for quick deployment when needed. If you **store Wip** in the bag for an **extended period**, make sure it is **completely dry**.

If you intend to transport Wip on the handlebar, which is possible on many folding **bikes or bicycles with small wheels (20")**, **rotate Wip in the bag** so that the **safety clip protrudes from the opening and can be clipped onto the bike**. Secure the bag to the handlebar using the existing velcro straps. **Always use at least two straps**.

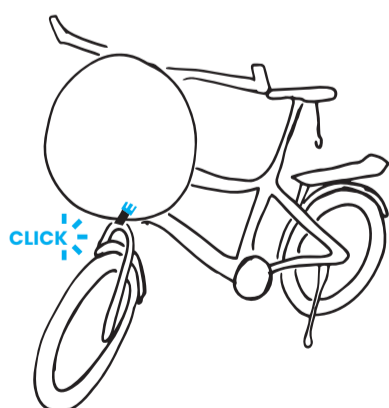

When transporting **Wip on the luggage rack**, it is recommended to position it **slightly towards the rear** so that Wip does not interfere with your pedaling. **Make sure that the bag, especially the yellow elastic band of the bag closure, does not get caught in the spokes. Otherwise, there is a serious risk of injury.**

If necessary, the safety clip can be removed from underneath the handlebar and mounted in this area as an additional fastening.

CARE INSTRUCTIONS:

Use a soft cloth and mild detergent for **cleaning**. To avoid **scratches**, the polycarbonate **viewing window** (like eyeglass lenses or helmet visors) should **never be cleaned with abrasive cleaners**. Do not expose Wip to **excessive heat** (e.g., behind a car window in the summer).

Material Composition of Wip:

Ripstop: Original kitesurf material, very lightweight yet highly tear-resistant
Macrolon (Polycarbonate): Original eyewear and visor material
PVC Viewing Window: Original windsurfing window material
Full Fiberglass Frame, Aluminum Handlebar Mounts
Composition:
30% Polyester / 30% Polycarbonate / 30% PVC / Aluminum / Full Fiberglass